

Quick Installation Guide

LTE-Advanced Mobile Wi-Fi
MODEL NO. M7300



7106505767 REV.2.0.0



For more information, please visit our website
<http://www.tp-link.com>

©2015 TP-LINK

Connecting to the Internet

1 Install the SIM card and battery

Remove the cover, and install the SIM card and battery as shown.

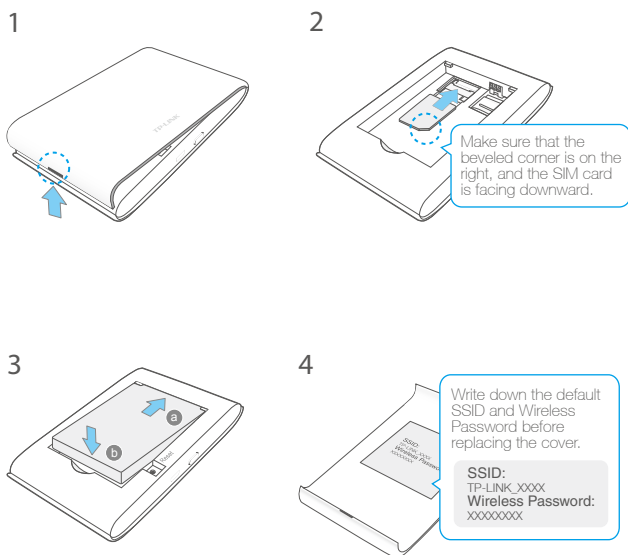

Note:

1. The SIM card is not provided by TP-LINK.
2. Micro or Nano SIM cards should be inserted using the provided SIM card trays.
3. Recommend using the provided battery.

2 Connect to the Internet

1 Power on

Press and hold the Power button until all the LEDs are lit. Please wait until the Internet Connection LED turns solid green. If not, please refer to FAQ > Q4.

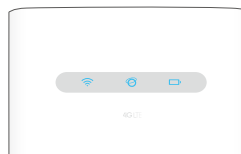

2 Connect devices to your Mobile Wi-Fi

On your wireless device or smart device, select the default M7300's SSID (**Network Name**) and enter the **Wireless Password**.

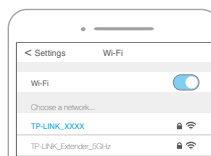

We highly recommend that you change the default wireless name and password for network security purposes.

Note: The M7300's Wi-Fi will automatically turn off if no Wi-Fi devices connect to the M7300 for 10 minutes. Press the Power button to turn Wi-Fi on again.



Managing the M7300 via tpMiFi App

How to download tpMiFi



1. Search for and install the tpMiFi mobile app from the Apple App Store or Google Play, or simply scan the QR code.
2. Connect your mobile device to the M7300's wireless network.
3. Launch tpMiFi and enter **admin** to log in.

How to use tpMiFi

1 Keep track of your data usage OR View data usage

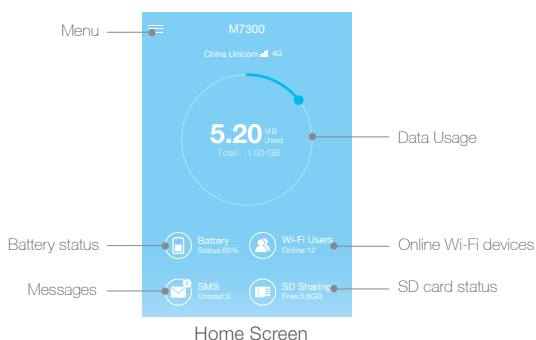

2 Manage network access

Tap **"Wi-Fi Users"** on the Home Screen, swipe left on the user or device you want to block.

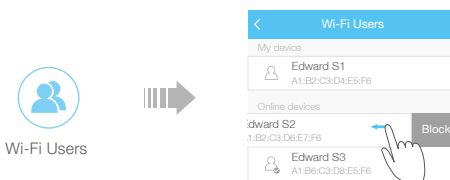

3 Share multimedia files

Tap **"SD Sharing"** on the Home Screen and select the sharing method via Wi-Fi Mode or USB Mode.

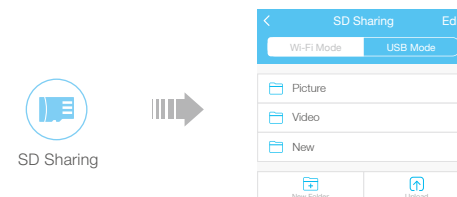

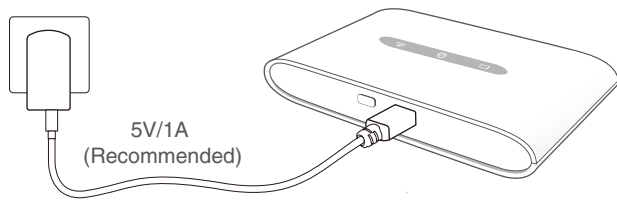

Charging the M7300

Method 1 Via the Wall Charger



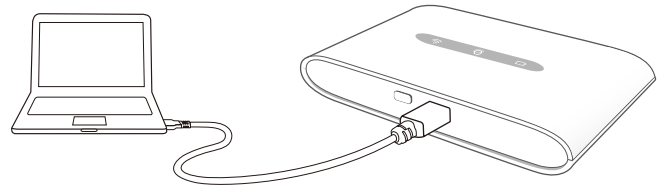



Method 2 Via a Computer



Note: The M7300 is fully charged when the  (Battery LED) is solid green.

LED Display

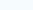
LED	Status	Indication
	On	The Wi-Fi connection is on.
	On	The M7300 is connected to the Internet.
	On	The M7300 is on.
	Red	The battery level is less than 10%.
	Blinking Green	The M7300 is charging.

The LEDs will turn off automatically after 15 seconds. Please press the Power button to turn them on again.

Safety Information

- Keep the device away from water, fire, humidity or hot environments.
- Do not attempt to disassemble, repair, or modify the device.
- Do not use damaged charger or USB cable to charge the device.
- Do not use any other chargers than those recommended.
- Do not use the device where wireless devices are not allowed.
- **Precaution: Explosion risk in case of battery substitution by one different. Battery disposable according to instructions.**

Please read and follow the above safety information when operating the device. We cannot guarantee that no accidents or damage will occur due to improper use of the device. Please use this product with care and operate at your own risk.

FAQ(Frequently Asked Questions)

Q1. Is there any other alternative to manage the M7300 besides the tpMiFi app?

- A. You can manage the M7300 by using its web management page.
1. Connect your Wi-Fi device to the M7300's wireless network.
 2. Open your web browser and type <http://tplinkmifi.net> or <http://192.168.0.1> into the address bar, then enter the default password **admin**, and click **Login**.

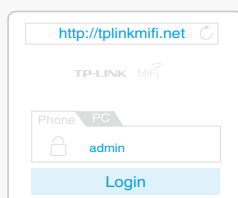

Q2. What should I do if I cannot log into the web-management page?

- Verify that your device is connected to the M7300.
- Verify that you have entered <http://tplinkmifi.net> or <http://192.168.0.1> correctly.
- Verify that your device is set to obtain an IP address automatically.

Q3. How do I restore the M7300 to its factory default settings?

- A. While the M7300 is powered on, remove the cover. Use a pin to press and hold the Reset button until all LEDs turn on momentarily.
- Note: Resetting the device to its factory defaults will clear all previous configuration.

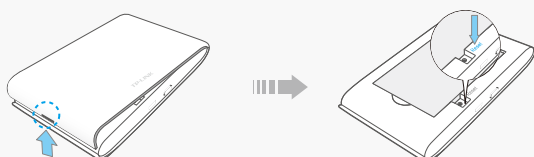

Q4. What should I do if the Internet Connection LED doesn't light up (cannot access the Internet)?

A1. Check PIN status

Refer to Q1 to log into the web-management page on your phone. If the current SIM card status is "PIN Locked", you will need to unlock it using the PIN code.

A2. Verify the ISP parameters

1. Refer to Q1 to log into the web-management page on your phone. Go to **Dial-up > View Profile Details** and verify the parameters (i.e. APN, Username, and Password) provided by your ISP are correctly entered.
2. If not, return to the Dial-up page and create a new profile with the correct information, then choose the new created profile from the Profile List.

A3. Check the Data Roaming settings

1. If your SIM card is operated in a roaming service area, refer to Q1 to log in to the web-management page on your phone.
2. Go to **Dial-up** and enable the **Data Roaming** option.

A4. Check Mobile Data

Refer to Q1 to log into the web-management page on your phone. Go to **Dial-up** to verify that **Mobile Data** is On. If not, enable this option.

A5. Check Data Limit

Refer to Q1 to log into the web-management page on your phone. Go to **Device > Data Usage Settings** to check whether your data usage has exceeded the Total/Monthly allowance.